



# Conseil Départemental des Hautes Pyrénées

Aménagement de la liaison Tarbes - Bagnères de Bigorre  
Section Soues / Arcizac-Adour

Synoptique de l'assainissement pluvial - Bassins versant 5(1) et 6

PHASE :







DLE

# 2.6

| Indice | Date     |
|--------|----------|
| a      | 26/02/13 |
| b      | 24/11/16 |
| c      | 18/01/17 |

Ech : 1 / 2 000

## LEGENDE

-  Bassin versant
-  Fossé routier
-  Busage
-  Dérivation du ruisseau d'Ordizan
-  Ouvrage de régulation
-  Poste de relevage

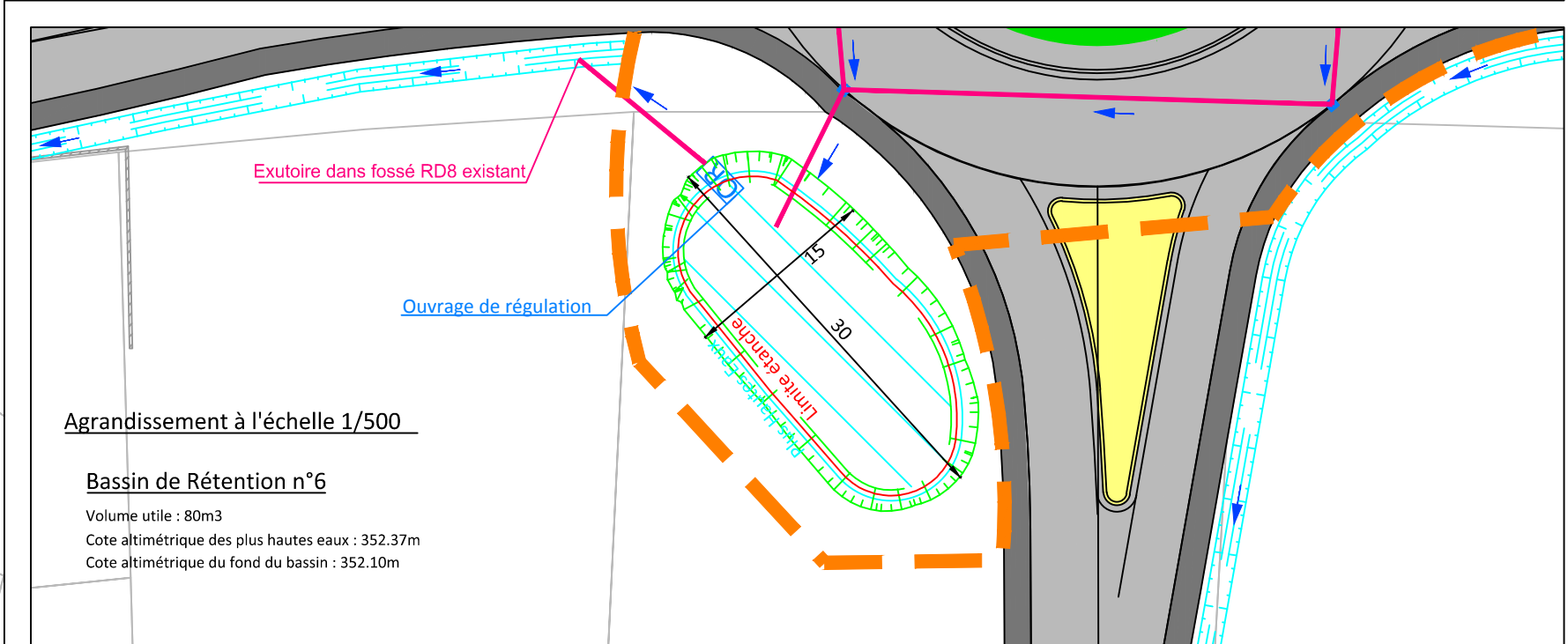
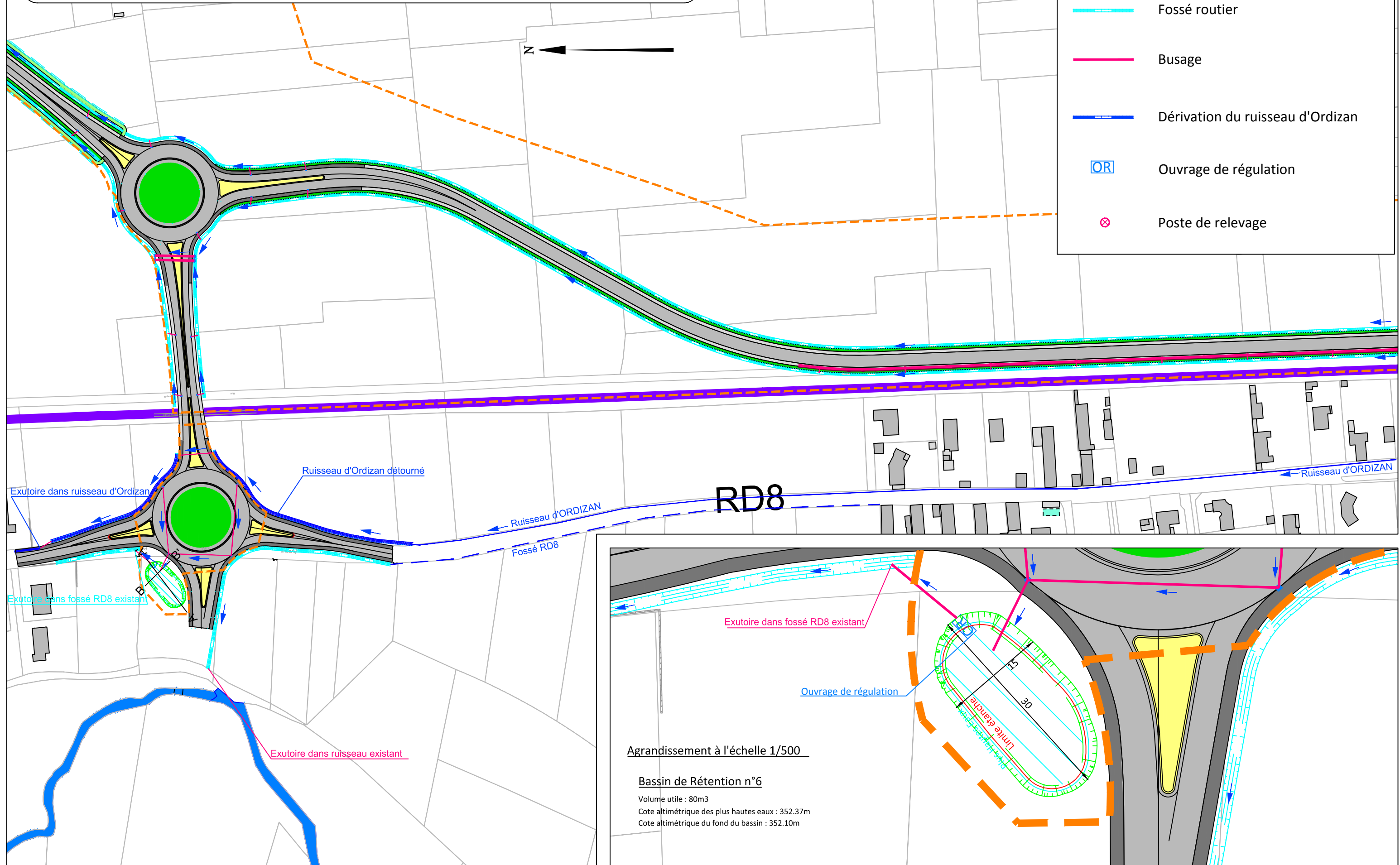

Agrandissement à l'échelle 1/500

**Bassin de Rétention n°6**

Volume utile : 80m<sup>3</sup>  
 Cote altimétrique des plus hautes eaux : 352.37m  
 Cote altimétrique du fond du bassin : 352.10m